



## SLA MAX

FACTORY ACTIVATED

SLA MAX | PREMIUM QUALITY READY TO START

# REF BTX20HL



**12V** VOLTAGE - V

**290A** CCA - A

**21.1Ah** CAPACITY - Ah (20Hr)

**20Ah** CAPACITY - Ah (10Hr)

### TECHNOLOGY

- AGM construction (Absorbed Glass Material)
- VRLA battery (Valve Regulated Lead Acid)
- Activated and pre-charged batteries
- Homologated by OEM

### FEATURES

- Factory activated : Ready-to-start battery
- Totally sealed
- Safe & Environmentally friendly
- Superior capacity
- Increased power & Extended life
- Low discharge rate
- Absolutely maintenance free
- Sealed, no gas emission through venting hole (under normal operation)
- Extreme vibration resistance
- Spillproof design
- Multi-positional fitment
- No acid handling - Very safe

### UPGRADE FOR

BTX20HL-BS & BTX20HL SLA

### WEIGHT

Battery (with acid) : approx 6.50kg

### MOUNTING ANGLE

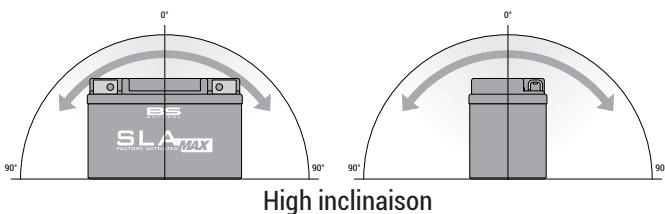

### DIMENSIONS

Length (A) : 176mm (±2mm)  
 Width (B) : 87mm (±2mm)  
 Container height : 153mm (±2mm)  
 Total height (C) : 153mm (±2mm)

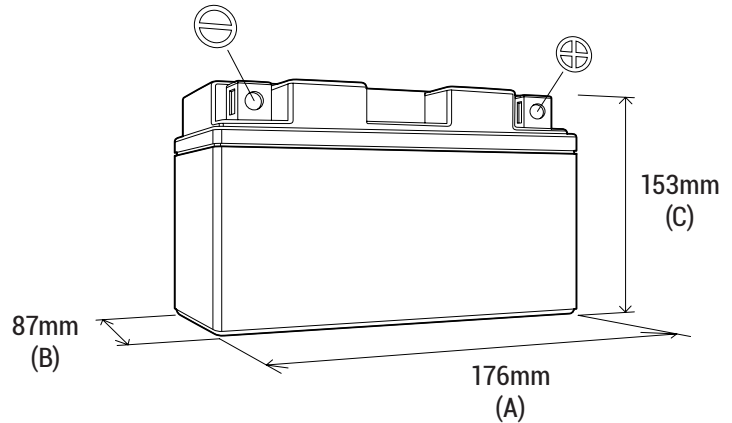

### TERMINALS

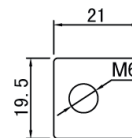

FRONT



SIDE

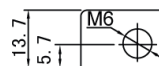

TOP